

# 322-SVW(-DS)

Plug-in terminal strip

Screw connection & pin, plug-in direction vertical, long pin

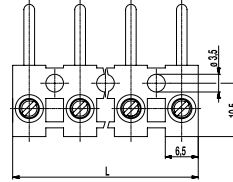
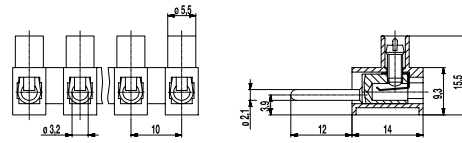

## GENERAL INFORMATION

Pitch	10 mm
No. of poles	2 - 12
Usable with	322-FBG(-DS), 323-FBW(-DS), 323-PHFBW(-DS)
Areas of application	Applications that require to easily open and close not energised circuits.

## TECHNICAL DATA

Clamping Range	<i>solid / stranded / AWG</i>		
without wire protector	0,5 - 4 mm <sup>2</sup> / 0,5 - 2,5 mm <sup>2</sup> / 20 - 12 AWG		
with wire protector	0,34 - 2,5 mm <sup>2</sup> / 0,34 - 2,5 mm <sup>2</sup> / 22 - 14 AWG		
Rated Cross Section	2,5 mm <sup>2</sup>		
Wire Stripping Length	7 mm ± 0,5 mm		
Overvoltage Category	III	III	II
Pollution Severity Level	3	2	2
Rated Voltage	400 V (160 V)	630 V (160 V)	1000 V (320V)
Rated Impulse Voltage	6 kV (2,5kV)	6 kV (2,5 kV)	6 kV (2,5 kV)
Rated Insulation Voltage	450 V acc. to EN 60998-1		
Rated Current	15 A		
Torque	0,5 Nm		
Other specifications	Rated values apply to use in combination with 323-FBW(-DS) and insulated substrates. Values in parentheses apply to use without insulated substrates.		

## APPROVALS

	Current [A]	Voltage [V]	Group	AWG	[Nm]
	20	300	B	18 - 12	0,51
	15	300	B	26-10 [1]	0,51
	10	300	D,E	26-10 [1]	0,51

## CONFIGURATIONS

Version	Poles	Item	Article number	Item	Article number	Length (L)	PU
Standard	2	322-SVW/02	60.821.012	322-SVW-DS/02	24.821.012	18,00 mm	2000
Standard	3	322-SVW/03	61.821.012	322-SVW-DS/03	25.821.012	28,00 mm	1000
Standard	4	322-SVW/04	62.821.012	322-SVW-DS/04	26.821.012	38,00 mm	800
Standard	5	322-SVW/05	63.821.012	322-SVW-DS/05	27.821.012	48,00 mm	100
Standard	6	322-SVW/06	64.821.012	322-SVW-DS/06	28.821.012	58,00 mm	100
Standard	7	322-SVW/07	65.821.012	322-SVW-DS/07	29.821.012	68,00 mm	70
Standard	8	322-SVW/08	66.821.012	322-SVW-DS/08	30.821.012	78,00 mm	70
Standard	9	322-SVW/09	67.821.012	322-SVW-DS/09	31.821.012	88,00 mm	60
Standard	10	322-SVW/10	68.821.012	322-SVW-DS/10	32.821.012	98,00 mm	50
Standard	11	322-SVW/11	69.821.012	322-SVW-DS/11	33.821.012	108,00 mm	50
Standard	12	322-SVW/12	70.821.012	322-SVW-DS/12	34.821.012	117,00 mm	50

## MATERIAL

Moulding	PA, natural, V-2
Comparative Tracking Index	CTI ≥ 600
Insulating Group	I
Temperature Range	-40°C up to 100°C
Screw	M3; zinc plated steel, blue passivated
Wire protector	Tin plated tin bronze
Plug	Tin plated brass

## OPTIONS / ACCESSORIES

- Marking options on the screw guides
- Leading plug for the protective conductor pole (not for use with 323-PHFBW(-DS))
- Moulding made of special polyamide for e.g. household appliances

[1] for 322-SVW-DS: 26 - 12 AWG

