

# Series 1007

- Universal field of application
- Compact design
- Short travel
- Contacting of assembled PCBs

### Mechanical Data

Center	1.27 mm/50 mil
Temperature Range	-30 °C - +120 °C
Full Travel	2.80 mm
Working Travel	2.40 mm
Pre-loaded Spring Force	0.25/ 0.25/ 0.40 N
Spring Force at Working Travel	0.70/ 1.00/ 1.70 N

### Electrical Data

Max. Current Rating	3.0 A
Typical Continuity Resistance	<= 30 mOhm

### Materials

Barrel	Bronze, gold plated
Spring	Spring Steel, gold plated
Plunger	Steel, CuBe
Receptacle	Bronze, gold plated

### Recommended Diameter of Drill

HP 2361.1 (Trolitax)	0.86 mm
with pressed-in Ring	0.93 mm
HGW 2372	0.88 mm
with pressed-in Ring	0.94 mm

### Tip style - Diameter - Plating

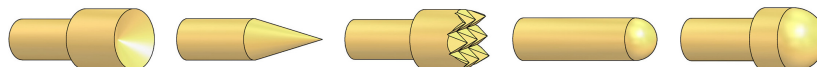

A	B	C	D	D
0.90 Au	0.49C Au	0.90C Au	0.49 Au	0.85C Au

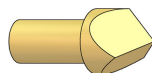

H
0.90 Au
1.50 Au

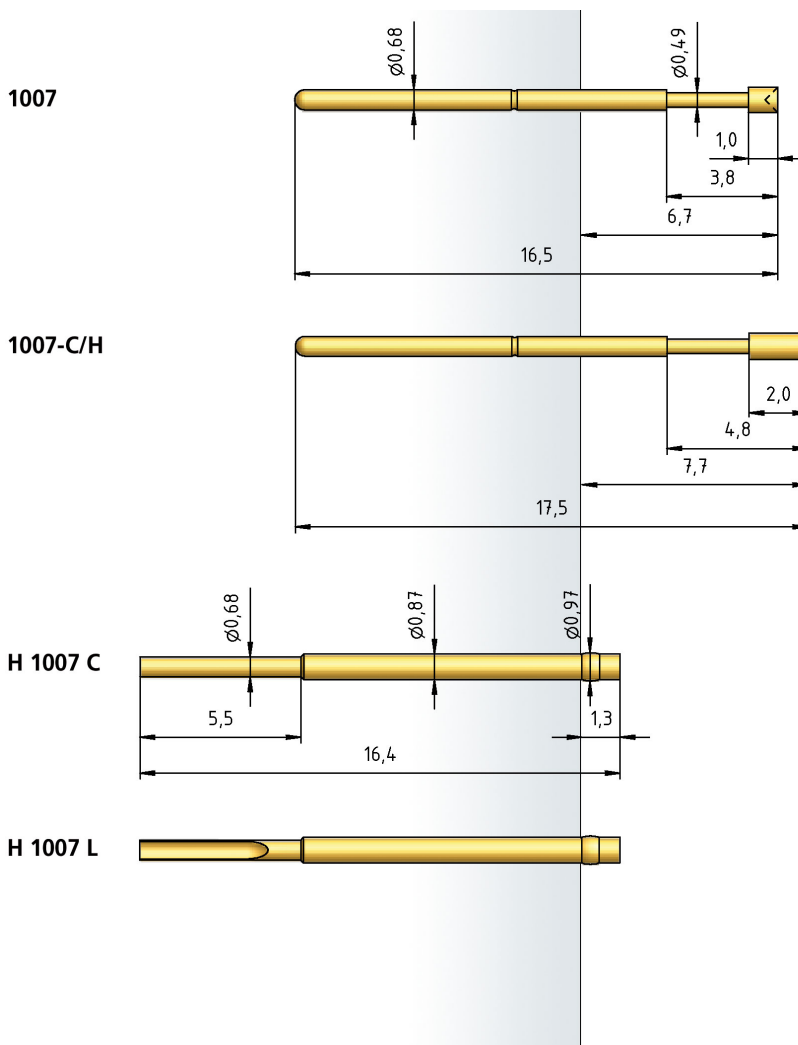

### How to Order

<u>1007</u>	-	<u>A</u>	-	<u>0.7 N</u>	-	<u>Au</u>	-	<u>0.9</u>	<u>C</u>
1	2	3	4	5	6				

1. Series 2. Tip Style 3. Spring Force  
 4. Tip Plating 5. Tip Diameter 6. Tip Material (only for CuBe)